



MAHARERA No. P52900016478  
[www.mahareraonline.mahaonline.gov.in](http://www.mahareraonline.mahaonline.gov.in)



GOA GREENS ELITE at the foothills of the Sahyadri range in Dodamarg is perfectly located to ensure that one has everything one could possibly hope while owning a second home. The Grandeur of the majestic Sahyadri as the backdrop and just a hop skip & jump from any magical location of Goa. The upcoming Airport of Mopa in North Goa being just a short drive. This is the perfect location to be in with dream amenities and a price that is quite simply unbelievable.



Goa  
Greens  
ELITE



## AMENITIES

-  Decorative streetlights
-  Underground cabling
-  Wide internal road
-  Secured gated complex
-  Boosted water supply
-  Landscaped gardens
-  Swimming pool with kids pool
-  24 hours security
-  Gymnasium
-  Huge clubhouse
-  Indoor games room
-  Yoga/meditation room
-  Multi purpose hall & coffee shop

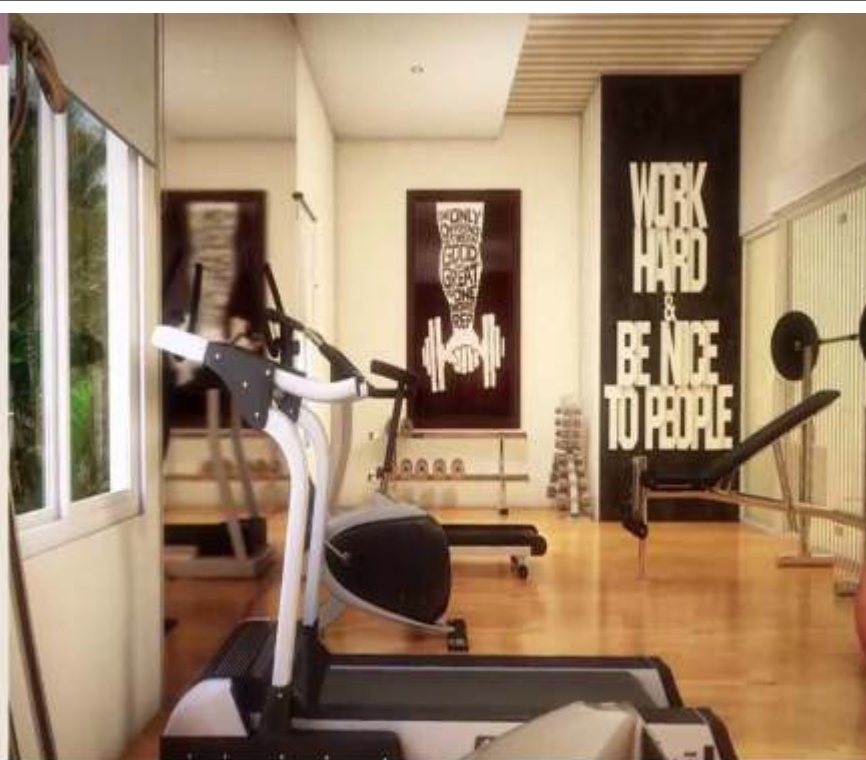

## SPECIFICATIONS

**Structural Features:** RCC framed structure of columns, beams and slabs.

**Flooring:** Vitrified flooring for full apartment.

**Toilet:** Toilet with mixer, western commode and washbasin, branded fittings and sanitary ware.

**Doors/Windows:** Teak wood main door and internal flush doors with veneer having polished brass accessories. Windows of Aluminum/UPVC of appropriate make.

**Kitchen:** Granite kitchen platform with stainless steel sink and 2ft height ceramic dado tiles above platform.

**Electrical:** High quality branded switches and wires.

**Wall finish:** External walls - Branded Apex paint  
Internal walls - Emulsion paints of appropriate make.

Provision for Inverter and AC's.

# FLOOR PLAN

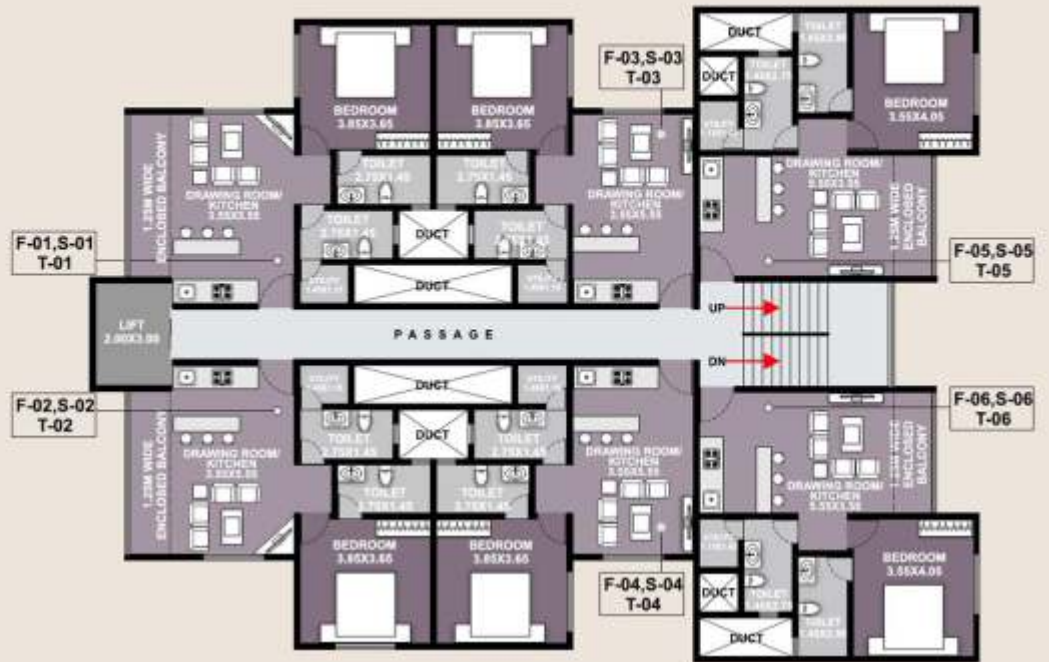

**BLOCK A**  
TYPICAL 1st, 2nd & 3rd FLOOR PLAN

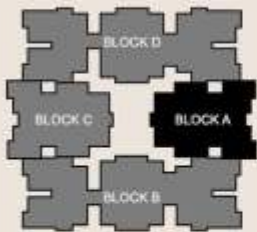

Flat no.	Type	Carpet Area	Covered Area	Super Built up Area
F-01,F-02,S-01,S-02,T-01,T-02	Type 4	45.97 Sqm	58.39 Sqm	72.99 Sqm
F-03,F-04,S-03,S-04,T-03,T-04	Type 1	45.23 Sqm	51.71 Sqm	64.64 Sqm
F-05,F-06,S-05,S-06,T-05,T-06	Type 3	46.64 Sqm	57.58 Sqm	71.98 Sqm



**BLOCK B**  
TYPICAL 1st, 2nd & 3rd FLOOR PLAN

Flat no.	Type	Carpet Area	Covered Area	Super Built up Area
F-01,F-12,S-01,S-12,T-01,T-12	Type 3	46.64 Sqm	57.58 Sqm	71.98 Sqm
F-02,F-03,F-05,F-06,F-07,F-08, F-10,F-11,S-02,S-03,S-05,S-06, S-07,S-08,S-10,S-11,T-02,T-03, T-05,T-06,T-07,T-08,T-10,T-11	Type 2	45.97 Sqm	56.82 Sqm	71.02 Sqm
F-04,F-09,S-04,S-09,T-04,T-09	Type 1	45.23 Sqm	51.71 Sqm	64.64 Sqm

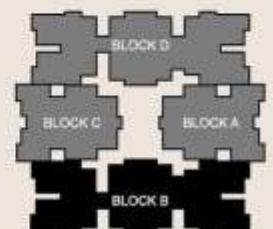

# FLOOR PLAN

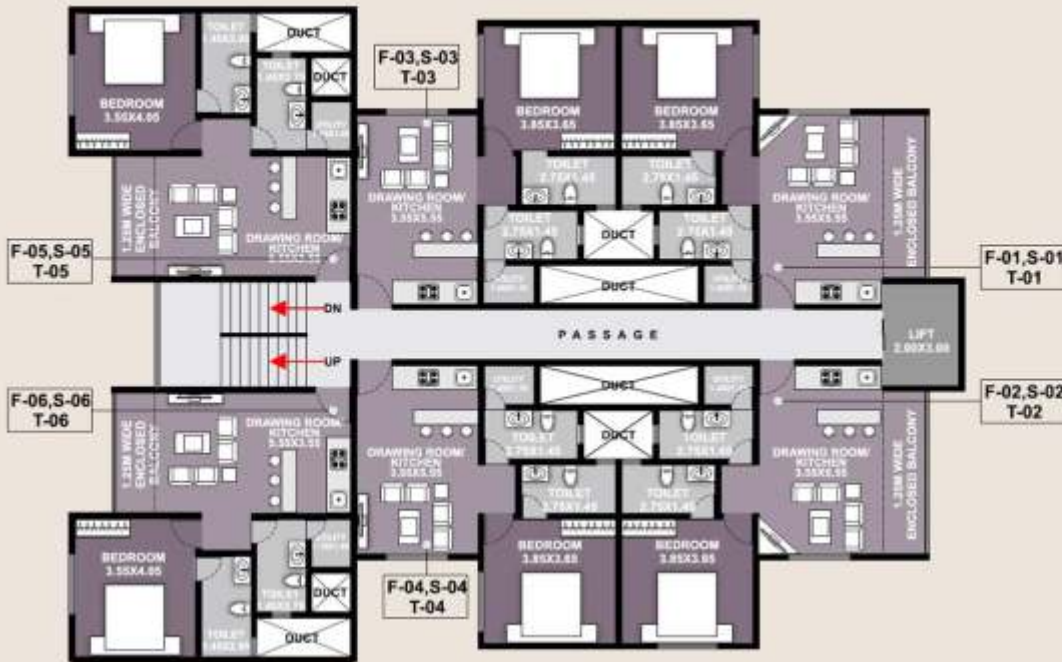

## BLOCK C TYPICAL 1st, 2nd & 3rd FLOOR PLAN

Flat no.	Type	Carpet Area	Covered Area	Super Built up Area
F-01,F-02,S-01,S-02,T-01,T-02	Type 4	45.97 Sqm	58.39 Sqm	72.99 Sqm
F-03,F-04,S-03,S-04,T-03,T-04	Type 1	45.23 Sqm	51.71 Sqm	64.64 Sqm
F-05,F-06,S-05,S-06,T-05,T-06	Type 3	46.64 Sqm	57.58 Sqm	71.98 Sqm

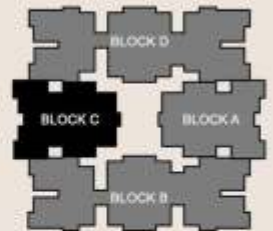

## BLOCK D TYPICAL 1st, 2nd & 3rd FLOOR PLAN

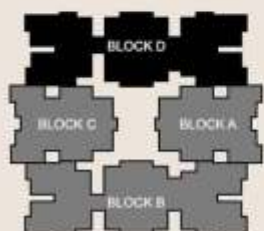

Flat no.	Type	Carpet Area	Covered Area	Super Built up Area
F-01,F-12,S-01,S-12,T-01,T-12	Type 3	46.64 Sqm	57.58 Sqm	71.98 Sqm
F-02,F-03,F-05,F-06,F-07,F-08, F-10,F-11,S-02,S-03,S-05,S-06, S-07,S-08,S-10,S-11,T-02,T-03, T-05,T-06,T-07,T-08,T-10,T-11	Type 2	45.97 Sqm	56.82 Sqm	71.02 Sqm
F-04,F-09,S-04,S-09,T-04,T-09	Type 1	45.23 Sqm	51.71 Sqm	64.64 Sqm

APARTMENT  
CONFIGURATION



TYPICAL 1 BHK | TYPE 3



TYPICAL 1 BHK | TYPE 4



MAHARERA No. P52900016478  
www.mahareraft.mahareraonline.gov.in

# APARTMENT CONFIGURATION



TYPICAL 1 BHK | TYPE 1

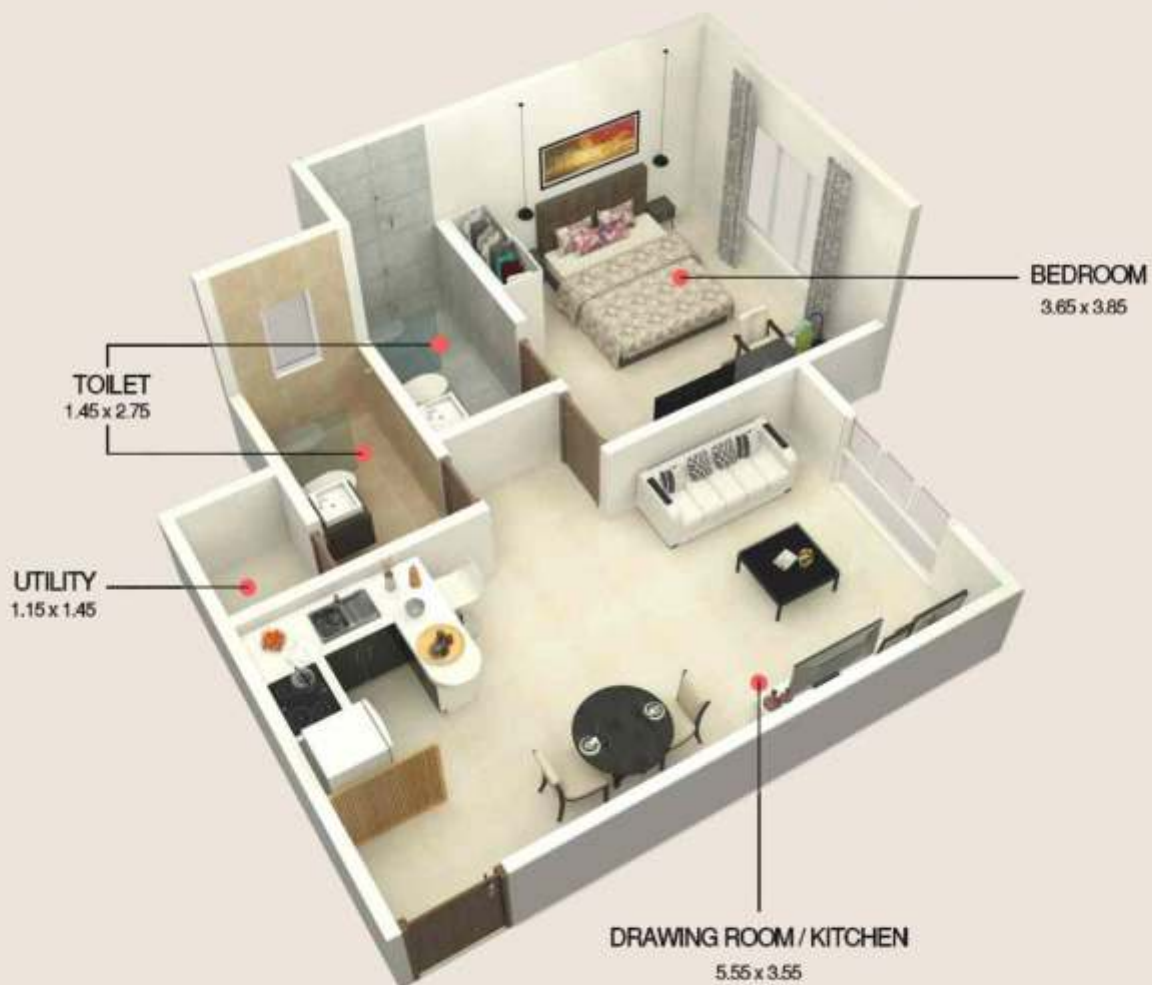

TYPICAL 1 BHK | TYPE 2



**Goa Greens  
ELITE**

MAHARERA NO. P52900016478  
www.mshareraalt.mshaonline.gov.in



GOA GREENS ELITE is set in an amazing picturesque locale right on the border of Goa-Maharashtra. Surrounded by beautiful hills, the place has a heavenly feel in all seasons. Within 3-4 min drive one crosses into Goa, giving you the best of both Konkan and Goa. As one drives from the project, the landmark places closest are Mapusa 22 minutes, Bicholim 12 minutes, Panaji 40 minutes, twin beaches of Anjuna and Vagator 35 minutes. On the Konkan railway, the Thivim railway station is the closest about 15 minutes drive. The upcoming Mopa airport again about a 15 minutes drive, making the project most convenient from air travel point of view. The new airport will also bring prosperity, business and good rental prospects to the region.



A Project by  
**Havi Homes Infrastructure Pvt. Ltd.**  
Strategic Partner  
**Ankit Projexcel**



**Site Address : Village Girode, Tal. Dodamarg, Dist. Sindhudurg**  
**Sales Office : Panjim : S-70, 2nd floor, Alfran Plaza, Near Don Bosco School, M. G. Road, Panjim, Goa - 403001**  
**Pune : Projexcel House, 2nd Floor, Next to Courtyard Marriott, Hinjewadi -Wakad Rd. Hinjewadi Phase 1, Pune, MH - 411 057**  
**Call Us : +91 8828292777 | 8828293777**  
**mail us : sales@hhinfrastructure.com**

The brochure is not a legal document. The visual representations shown in the brochure are purely conceptual and the information contained is indicative of the proposed development. All villas plans, specifications, layouts etc. are tentative and subject to modifications by the developer or the architect or competent authorities sanctioning the plan. Furniture, fittings and fixtures shown may not be provided by the developer. Drawings are not to scale. Dimensions are approximate and actual usable floor space may vary from the stated floor plan.